

# TEC SKIN<sup>™</sup>

## Installation Instructions

### For Hyundai Santa Cruz



For proper installation and best possible fit, please read all instructions BEFORE you begin.

### Important Information

BEFORE you begin the installation process:

- Carefully read all instructions.
- Verify that all parts are included by checking the contents of your kit.

If any parts are missing or appear damaged, please contact our customer service team for assistance.

### Customer Service

For support, please contact the Putco team, available Monday to Friday 8:30 AM to 5PM (Central Time).

1 800 247 3974

support@putco.com

### Supported Vehicles

MAKE	MODEL	YEAR
HYUNDAI	SANTA CRUZ	2022-2025

## Recommended Tools + Supplies

3/16" HEX KEY	KNIFE OR RAZOR BLADE
RUBBER BANDS OR TAPE	2.5 MM HEX KEY

## Kit Contents

2 TEC SKIN EXTRUSIONS WITH END CAPS	4 MOUNTING BRACKETS	HARDWARE KIT
-------------------------------------	---------------------	--------------

## Stake Pocket Assemblies

### Front & Rear

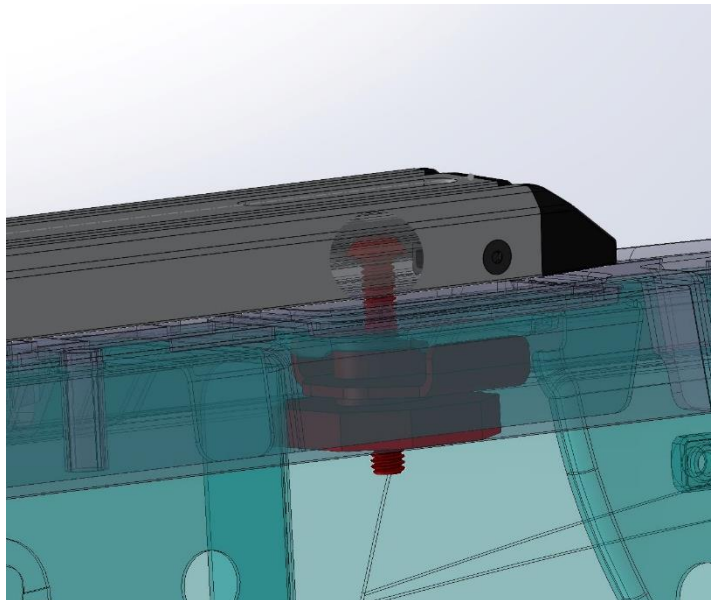

## Step by Step Installation

1. Retrieve the four extrusion end caps and eight black M4 screws from your kit, along with the two Tec Skin aluminum extrusions.



2. Push the end caps into the ends of the Tec Skin extrusions so that the threaded holes in the end caps line up with the counter sunk holes in the extrusion.
3. Install the M4 screws into the extrusions and end caps using a 2.5mm hex key.



4. Use a knife or razor blade to cut open the front and rear stake pockets on your vehicle's bed cap, if not already exposed.



5. Unbox the hardware kit and identify the four plastic bracket plates and 5/16" x 3.25" long bolts.
6. Join the plastic bracket plates and the rear stake pocket brackets and thread the 5/16" bolts into the plastic bracket plates, as shown.



7. Install the bracket assemblies by guiding the head of the 5/16" bolts into the single channel on the bottom of the Tec Skin extrusion.



8. Identify which end of the extrusion is the rear, it will be marked with a white etch in front of the rear mounting slot, as shown. This end will go towards the tailgate (rear) of the vehicle.
9. Ensure the bed cap of the vehicle is clean and free from dirt and debris.



10. Pick up the extrusion with the bracket assemblies and 5/16" bolts installed and guide the bracket assemblies into the stake pockets, as shown. Ensure the flanged edges grab the sides of the vehicle's stake pocket.



11. Tighten the 5/16" bolts with a 3/16" hex key until the extrusions lay flat on the bed. Do not fully tighten yet.

TIP: Apply upward force on the extrusion during initial tightening to prevent the stake pocket bracket from spinning.



12. Position the extrusions in the desired final position and fully tighten the 5/16" bolts with a 3/16" hex key until they are secured.
13. Check that the Tec Skin extrusions and all fasteners are secure before driving the vehicle.

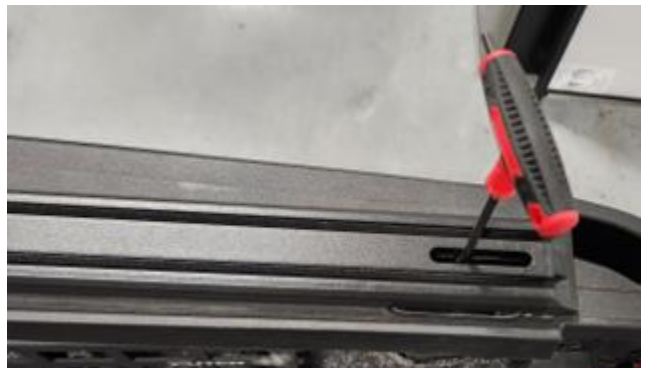

Congratulations on completing the installation of your Putco product!  
For information regarding your warranty, please visit [www.putco.com/warranty](http://www.putco.com/warranty).

**Issues? Please Contact Our Technical Support Team: 1 800 247 3974**



For additional information, please visit our website  
at [www.putco.com](http://www.putco.com)!